

PART NUMBER	WEATHERHEAD PART NUMBER	"T" TH'D REF	A REF	B REF	C REF	D REF	E REF	F REF	G REF	H REF	K REF
4401-4S		7/16-20	1.97	.85	1.10	.37	.13	.56	.62	.56	1.22
4401-5S		1/2-20	2.12	.94	1.20	.40	.17	.62	.69	.62	1.34
4401-6S	24706N-406	5/8-18	2.36	1.03	1.30	.43	.22	.75	.81	.75	1.46
4401-8-6S		3/4-16	2.42	1.08	1.30	.44	.22	.88	.81	.88	1.53
4401-8S		3/4-16	2.78	1.18	1.65	.44	.36	.88	.94	.88	1.62
4401-10S		7/8-14	3.10	1.29	1.80	.52	.45	1.00	1.12	1.00	1.81
4401-12S	24712N-412	1 1/16-14	3.49	1.35	2.10	.57	.55	1.25	1.25	1.25	1.92
4401-10-12S		7/8-14	3.40	1.31	2.10	.52	.48	1.00	1.25	1.00	1.83

REVISIONS			
REV	DESCRIPTION	DATE	APPROVED
AH	REDRAWN AND REVISED, LAST REV. "AG"	2005-06-30 RW	EN-F28067 DP-1299
AJ	1) ADDED PART #4401-8-6S. 2) "E" REF DIMENSION WAS .24 3) "E" REF DIMENSION WAS .46	2014-06-24 VPC	0099224- ECO RPS 38641

Ⓐ<sub>2</sub>  
Ⓐ<sub>1</sub>  
Ⓐ<sub>3</sub>

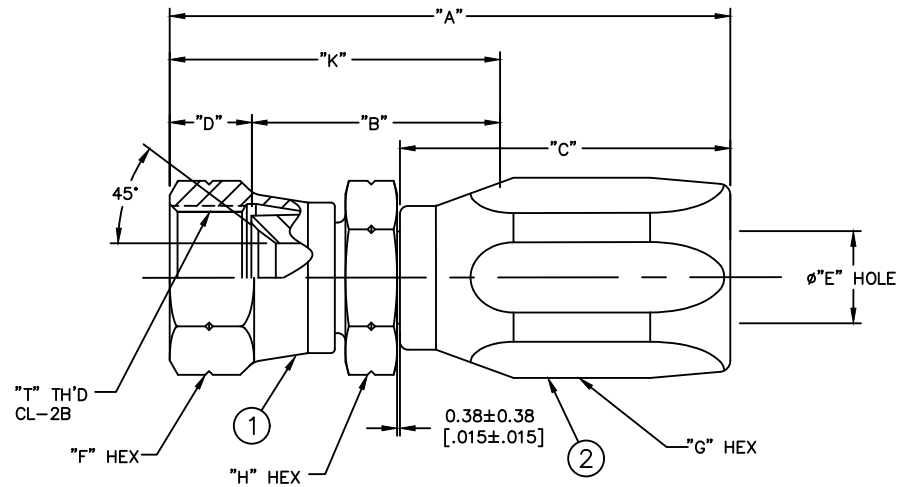

Ⓐ<sub>1</sub>

4401-10-12S		2401-10-12S	1210-12S		
4401-12S	24712N-412	2401-12S	1210-12S		
4401-10S		2401-10S	1210-10S		
4401-8S		2401-8S	1210-8S		
4401-8-6S		2401-8-6S	1210-6S		
4401-6S	24706N-406	2401-6S	1210-6S		
4401-5S		2401-5S	1210-5S		
4401-4S		2401-4S	1210-4S		
PART NUMBER	WEATHERHEAD PART NUMBER	Ⓐ NIPPLE ASSEMBLY	Ⓑ SOCKET		

LIST OF MATERIALS

ITEM NO.	MATERIAL	DRAWN L. CURRY	CHECKED R. WERMER	APPROVED R. WERMER	RELEASE DATE 2005-08-05	EN-F28067 DP-1299	SIZE A2	DRAWING NUMBER 4401	REV AJ
1	STEEL								
2	STEEL								
		THIRD ANGLE PROJECTION		SCALE * DIST U		CAGE CODE 01276		SHEET 1 OF 1	

**Danfoss** FLUID CONVEYANCE DIVISION  
DRAWING TITLE  
**FITTING ASSEMBLY**  
FEMALE SAE 45° SWIVEL, 1503 HOSE

1. DIMENSIONS ARE IN INCHES.

INCH

THE REPRODUCTION, DISTRIBUTION AND UTILIZATION OF THIS DOCUMENT AS WELL AS THE COMMUNICATION OF ITS CONTENTS TO OTHERS WITHOUT EXPLICIT AUTHORIZATION IS PROHIBITED. OFFENDERS WILL BE HELD LIABLE FOR THE PAYMENT OF DAMAGES. ALL RIGHT RESERVED IN THE EVENT OF THE GRANT OF A PATENT, UTILITY MODEL OR DESIGN. (PER ISO 16016)