

REVISIONS			
REV	DESCRIPTION	DATE	APPROVED
H	REDRAWN - SUPERSEDES 1SA_FJB8 SHEET 1/2 REV."G" FOR 1SA10FJB8 (1) WAS 13.7 REF (2) WAS 70.8 REF (3) WAS 30.3+2.4-0.5	11-9-95	EN-F16025 DP-24900
J	1) NOTE #1 (b) WAS "ZINC PLATE PER ACES 2751".	2020-05-26 AKG	CO-0203629

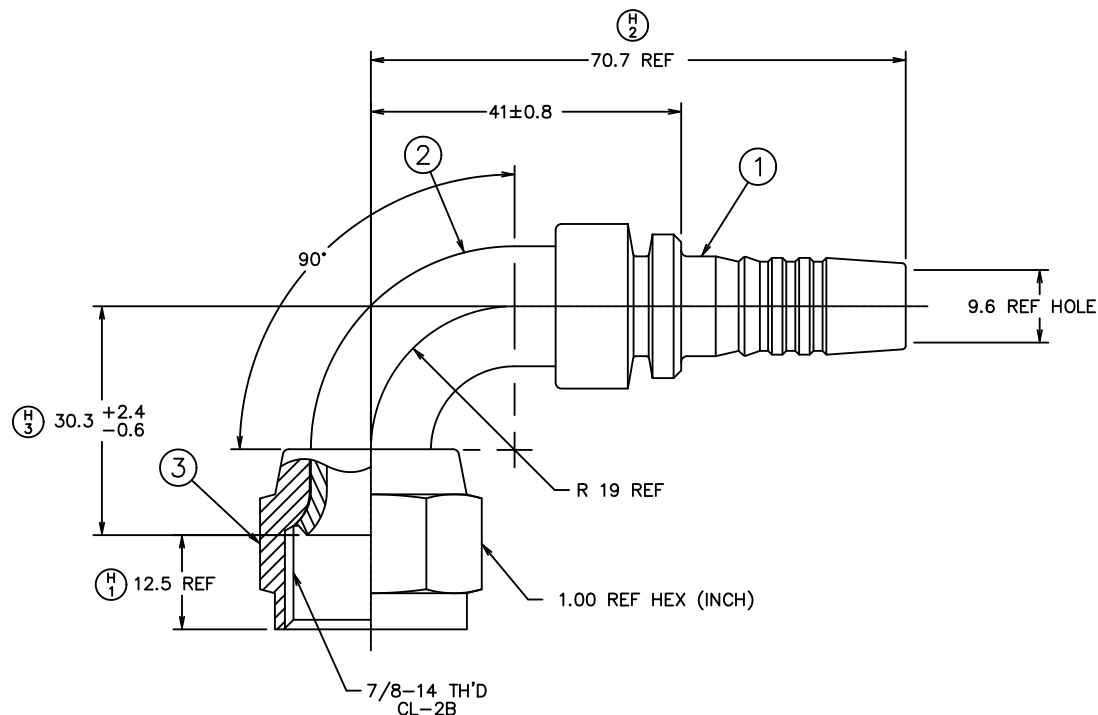

70.7	2.78
41±0.8	1.614±.031
30.3 +2.4/-0.6	1.19 +.10/-0.02
19	.75
12.5	.49
9.6	.38
MM	INCH

CONVERSION

METRIC

△ CAN BE MADE FROM TUBING PER SPECIFICATIONS ON ELBOW DRAWING.

1. PROCESS AS FOLLOWS:

(a) BRAZE PER ACES 2814.

(b) ZINC PLATE PER ES 2751D8. (H1)

(c) ASSEMBLE NUT AND FLARE ELBOW PER FF481.

1SA10FJB8	1F40014-1008AB	1F40016-10-01AB	210221-10S		
AEROQUIP PART NUMBER	(1) NIPPLE	(2) ELBOW	△ (3) NUT		
LIST OF MATERIALS					
ITEM NO.	MATERIAL	DRAWN R.D.GARRETT	FLUID CONVEYANCE DIVISION		
		CHECKED M. MOLINA	DRAWING TITLE		
1	STEEL	APPROVED R.D.GARRETT	NIPPLE ASSEMBLY		
2	STEEL	RELEASE DATE 1995-11-10	90°, SAE 37" SWIVEL		
3	STEEL	EN-F16025	2781 HOSE		
		DP-24900	SIZE A2	DRAWING NUMBER 1SA10FJB8	REV J
		THIRD ANGLE PROJECTION	SCALE 2/1	DIST U	CAGE CODE 01276
				SHEET 1	
THE REPRODUCTION, DISTRIBUTION AND UTILIZATION OF THIS DOCUMENT AS WELL AS THE COMMUNICATION OF ITS CONTENTS TO OTHERS WITHOUT EXPLICIT AUTHORIZATION IS PROHIBITED. OFFENDERS WILL BE HELD LIABLE FOR THE PAYMENT OF DAMAGES. ALL RIGHT RESERVED IN THE EVENT OF THE GRANT OF A PATENT, UTILITY MODEL OR DESIGN. (PER ISO 16016)					