

THE REPRODUCTION, DISTRIBUTION AND UTILIZATION OF THIS DOCUMENT AS WELL AS THE COMMUNICATION OF ITS CONTENTS TO OTHERS WITHOUT EXPLICIT AUTHORIZATION IS PROHIBITED. OFFENDERS WILL BE HELD LIABLE FOR THE PAYMENT OF DAMAGES. ALL RIGHT RESERVED IN THE EVENT OF THE GRANT OF A PATENT, UTILITY MODEL OR DESIGN. (PER ISO 18018)

REVISIONS

REV	DESCRIPTION	DATE	APPROVED
A	REDRAWN - SUPERSEDES 1GA_FJA_REV. "NONE" FOR 1GA10FJA10 (1) WAS 13.7 REF (2) WAS 69.4 REF	12-13-95	EN-F16130 DP-24900

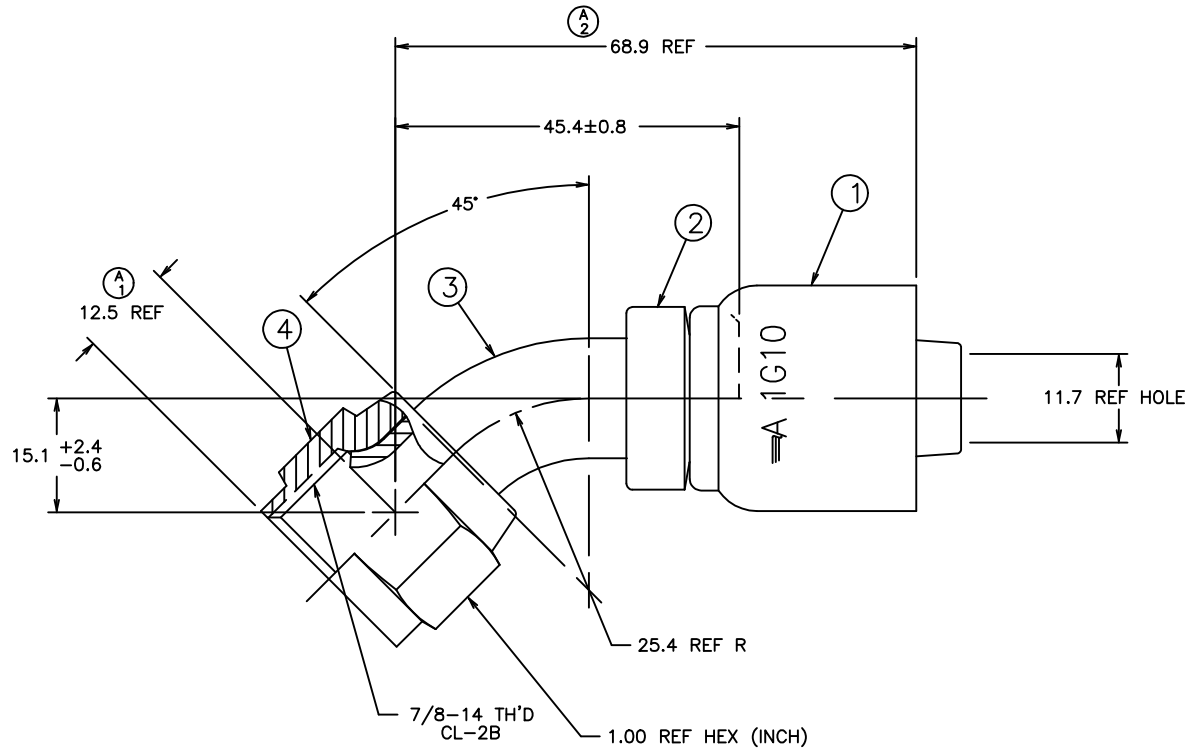

68.9	2.71
45.4±0.8	1.787±.031
25.4	1.00
15.1 +2.4/-0.6	.59 +.10/-0.02
12.5	.49
11.7	.46
MM	INCH

CONVERSION

METRIC

1GA10FJA10	1G10	1F40014-1010AB	1F40017-10-01AB	210221-10S
AEROQUIP PART NUMBER	① SOCKET	② NIPPLE	③ ELBOW	④ NUT
LIST OF MATERIALS				
ITEM NO.	MATERIAL	DRAWN J.L. HUFFMAN		
1	STEEL	CHECKED R.GARRETT		
2	STEEL	APPROVED R.GARRETT		
3	STEEL	RELEASE DATE 12-13-95		
4	STEEL	EN-F16130 DP-24900		
		SIZE C	DRAWING NUMBER 1GA10FJA10	REV A
		SCALE 2/1	DIST U	CAGE CODE 01276 SHEET NO

- △ CAN BE MADE FROM TUBING PER SPECIFICATIONS ON ELBOW DRAWING.
- 1SA10FJA10 NIPPLE ASSEMBLY MAY BE SUBSTITUTED FOR ITEMS #2, #3 AND #4.
 - PROCESS AS FOLLOWS:
 - BRAZE PER ACES 2814.
 - ZINC PLATE PER ACES 2751.
 - ASSEMBLE NUT AND FLARE ELBOW PER FF481.
 - ASSEMBLE SOCKET PER ACES 2813.

REV. A
SH. A
1GA10FJA10
DWG. NO.

CONVERTED DRAWING CADAM to AutoCAD 8/98