

REVISIONS			
REV	DESCRIPTION	DATE	APPROVED
L	1) NOTE #1(b) WAS "ZINC PLATE PER ES 2751."	2020-07-09 AKG	CO-0205712

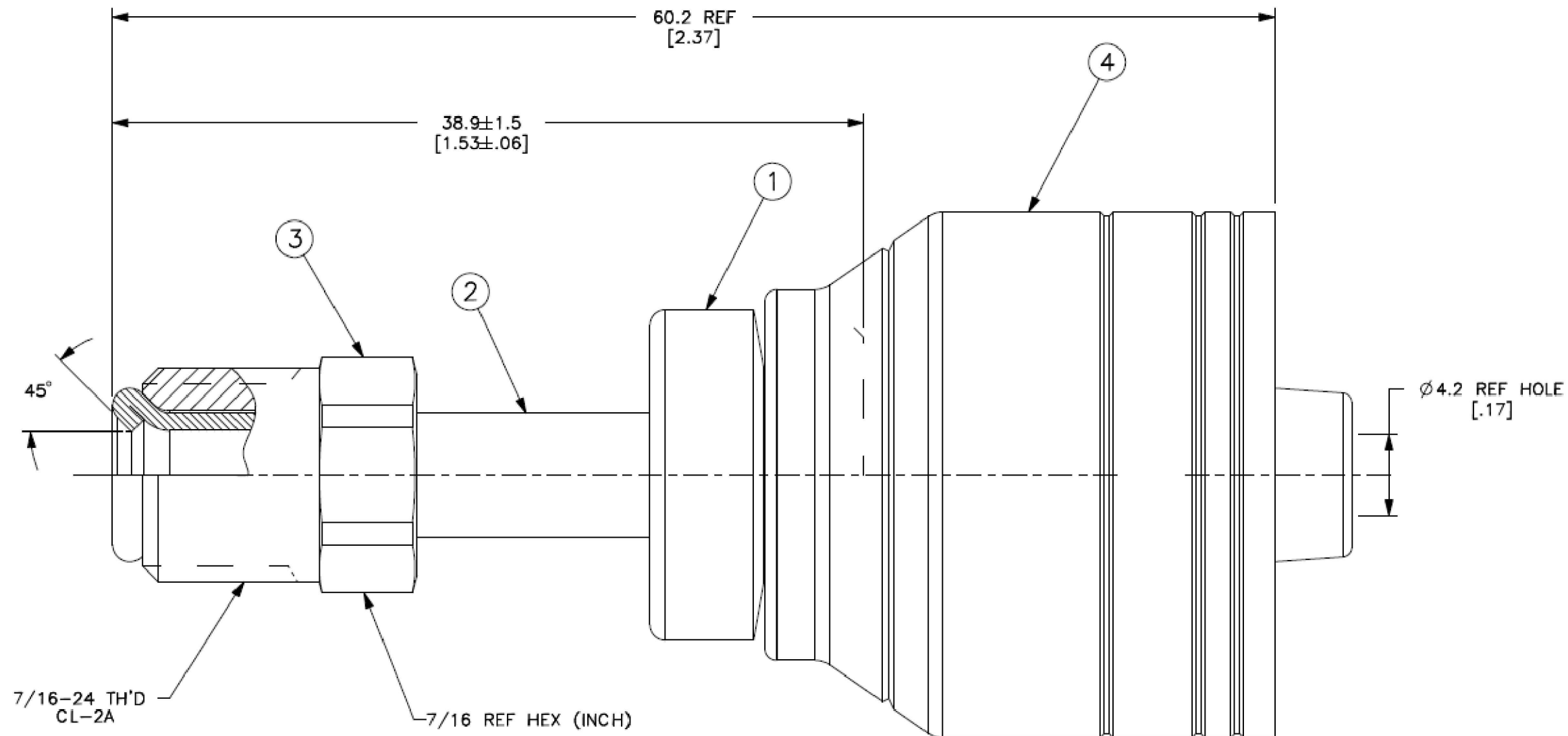

3. DIMENSIONS ARE IN MILLIMETERS [INCHES].
2. 1SA4MF6 NIPPLE ASSEMBLY MAY BE SUBSTITUTED FOR ITEMS #1, #2, AND #3.
1. PROCESS AS FOLLOWS:
- (a) ASSEMBLE NUT AND BRAZE PER ACES 2814.
 - (b) ZINC PLATE PER ES 2751D8. (1)
 - (c) ASSEMBLE SOCKET PER ACES 2813.

06Z-B04	1AA4MF6	1F40014-0406AB	400112-4S-1.250	186-1299-4	1A6
WEATHERHEAD PART NUMBER	AEROQUIP PART NUMBER	(1) NIPPLE	(2) FLARED TUBE	(3) NUT	(4) SOCKET

LIST OF MATERIALS

ITEM NO.	MATERIAL	DRAWN	FLUID CONVEYANCE DIVISION		
1	STEEL	D. POL	 DRAWING TITLE FITTING ASSEMBLY SAE MALE INVERTED FLARE 1 AND 2 WIRE BRAIDED HOSE		
2	STEEL	CHECKED			
3	STEEL	A. NAGARKATTI			
4	STEEL	A. NAGARKATTI			
		APPROVED	RELEASE DATE	SIZE	DRAWING NUMBER
		2007-10-22	0007770-ECO	A2	1AA4MF6
		DP-1693	THIRD ANGLE PROJECTION	SCALE	DIST
				5/1	U
				CAGE CODE	SHEET
				01276	1

THE REPRODUCTION, DISTRIBUTION AND UTILIZATION OF THIS DOCUMENT AS WELL AS THE COMMUNICATION OF ITS CONTENTS TO OTHER WITHOUT EXPLICIT AUTHORIZATION IS PROHIBITED. OFFENDERS WILL BE HELD LIABLE FOR THE PAYMENT OF DAMAGES. ALL RIGHT RESERVED IN THE EVENT OF THE GRANT OF A PATENT, UTILITY MODEL OR DESIGN. (PER ISO 16016)