

DISPLACEMENT CODE	G	MAX
022	132.7	[5.22]
025	133.5	[5.26]
028	132.7	[5.22]
035	136.5	[5.37]
045	136.5	[5.37]
059	139.5	[5.49]
073	142.8	[5.62]
089	146.4	[5.76]
097	148.2	[5.84]
113	151.7	[5.97]
141	158.1	[6.22]
179	166.7	[6.56]
226	177.1	[6.97]
451	228.0	[8.98]

SYM	REVISION	BY	DATE	ECN
A	ENGINEERING RELEASE	RLL	11-10-87	14736
H	-1>UPDATED TO CURRENT STANDARD-2>(4D) UPDATED TAB FOR G MAX	SSD	10-19-10	M80231
J	-1>REVISED PICTORIALLY -2>(4D)UPDATED TABULATION FOR G MAX	AAB	02-17-14	0054756
K	(1C>ADDED DANFOSS LOGO TO ENDCAP	AAB	01-22-15	0061684
L	(4A) NOTE 3 WAS CASE DRAIN : 1...	JVD	07-27-15	0065202
M	REMOVED DANFOSS LOGO	SSD	04-23-21	0131343

FOR SHAFT CONFIGURATION SEE SEPARATE SHAFT DRAWINGS.

GROOVE PROVIDED FOR 82.6[3.25] I.D. X 2.62[.103] CROSS SECTION O-RING. (DASH NO. 152)

FOR PORT CONFIGURATION SEE SEPARATE PORT DRAWING

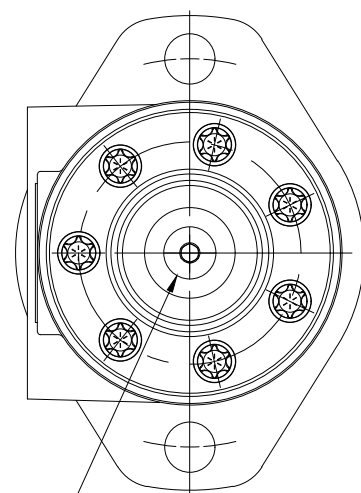
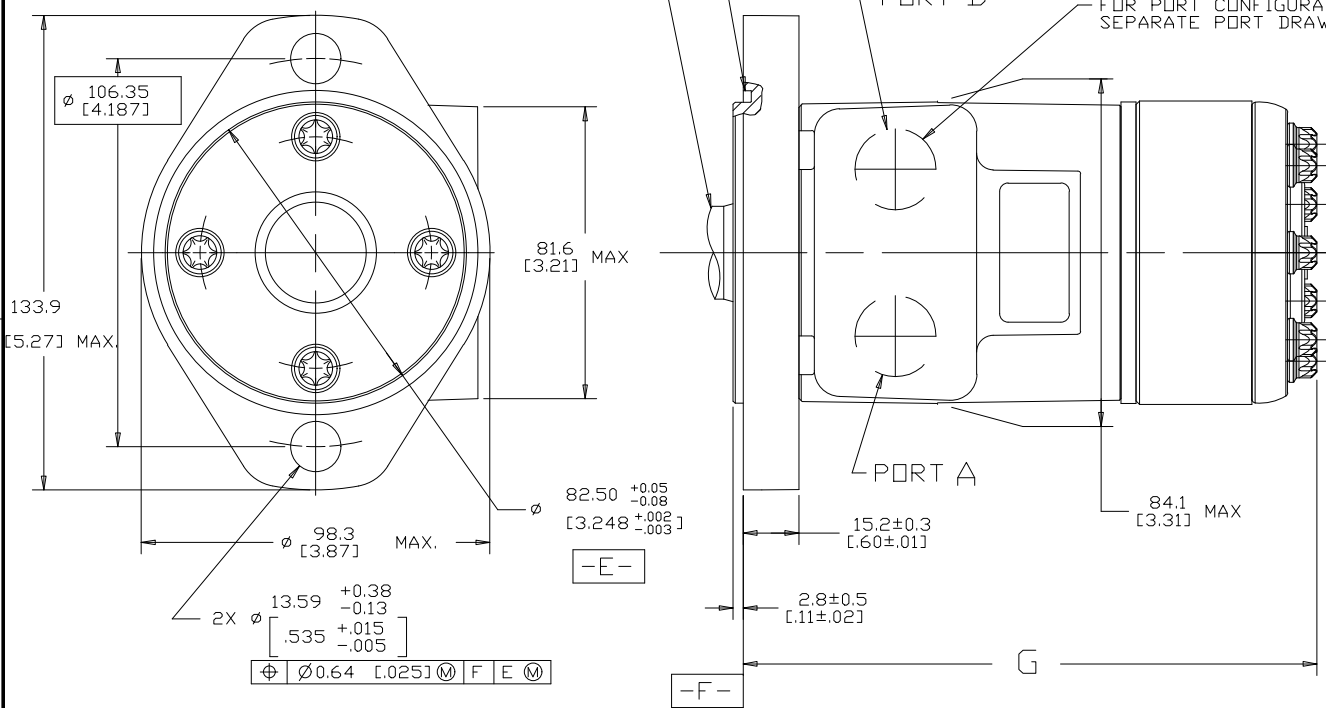

SAE J1926/1:7/16-20 O-RING PORT CASE DRAIN. WHEN REQUIRED, REMOVE O-RING PLUG. DRAIN LINE MUST BE CONNECTED THRU 3.4 bar [50 lbf/in²] MIN. CHECK VALVE TO RESERVOIR.

NOTE:

- 1. ROTATION:**
STANDARD; WHEN FACING SHAFT END OF MOTOR, SHAFT TO ROTATE CLOCKWISE WHEN PORT "A" IS PRESSURIZED. COUNTERCLOCKWISE WHEN PORT "B" IS PRESSURIZED.

REVERSE ; WHEN FACING SHAFT END OF MOTOR, SHAFT TO ROTATE CLOCKWISE WHEN PORT "B" IS PRESSURIZED. COUNTERCLOCKWISE WHEN PORT "A" IS PRESSURIZED.
- 2. MOUNTING FLANGE:**
AA = 2 BOLT STD : $\phi 82.50[3.248]$ X 3.05[.120] PILDOT, $\phi 13.59[.535]$ MOUNTING HOLES ON $\phi 106.2[4.18]$ BOLT CIRCLE
- 3. CASE DRAIN:**
01 = .4375-20 (END CAP)

CS REVIEWED FOR CLASSIFICATION PER ESP-042

UNLESS OTHERWISE SPECIFIED ALL DIMENSIONS ARE IN INCHES		DRAWING BASED ON ANSI Y14.5M-1982	
MILLIMETERS (INCHES)	<input type="checkbox"/>	THE REPRODUCTION, DISTRIBUTION, AND UTILIZATION OF THIS DOCUMENT, AS WELL AS THE COMMUNICATION OF ITS CONTENTS TO OTHERS WITHOUT EXPLICIT AUTHORIZATION IS PROHIBITED. OFFENDERS WILL BE HELD LIABLE FOR THE PAYMENT OF DAMAGES. ALL RIGHTS RESERVED IN THE EVENT OF THE GRANT OF A PATENT, UTILITY MODEL, OR DESIGN. (PER ISO 10016)	
TOLERANCES	<input checked="" type="checkbox"/>		
.X ± -			
.XX ± -		DRAWN BY/DATE	RLL 10-20-87
.XXX ± -		CHECKED BY/DATE	KG 1-21-88
< ± -		ENGRG BY/DATE	VCV 1-25-88
UNSPECIFIED RADII ARE:		METALLURGY BY/DATE	-
UNSPECIFIED DRAFT ANGLES ARE:		TITLE	
- - -		H MOTOR INSTALLATION	
C SIZE	<input checked="" type="checkbox"/>	NUMBER	A-37-311
THIRD ANGLE PROJECTION	<input checked="" type="checkbox"/>	SCALE	1/1 SHEET 1 OF 1
ARITHMETICAL AVERAGE	<input checked="" type="checkbox"/>		